

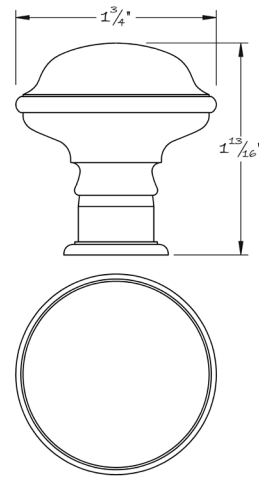

LOWE HARDWARE

No. 5020



*Sharing the same neck, body shape, and dimensions as the #5021,
Lowe Hardware's #5020 knob finishes the head off with an elliptical dome.
Pictured knobs are cabinet sized versions showing Lowe Hardware's ability to scale all its designs.
Generally, cabinet sizes come in 3/4", 1", 1-1/4", 1-1/2", and 1-3/4" diameters.
Available in any of our yacht quality electroplated or patinated finishes.*

• DESIGNED, MANUFACTURED & HAND FINISHED IN MAINE SINCE 1977 •

73 SPRING STREET NEW YORK, NY 10012 (212) 390-0660

WWW.LOWE-HARDWARE.COM